

Low Cost & Fast Delivery

Wire Rope Lanyards



**STAINLESS
STOCKED**

AUTOMATED MANUFACTURING PROVIDES:



- High quality
- Low prices
- Fast delivery
- Competitive with imports

Pivot Point manufactures high-quality Wire Rope Lanyard assemblies, which are typically used as tethers for pins and other components to prevent loss, as well as for door restraint cables and other uses.

Stock lanyards are available in 3/64" or 1/16" diameter wire rope. Choose from galvanized or stainless cable, coated or uncoated, 6" or 12" length and Type 1, 2 or 3 configuration.

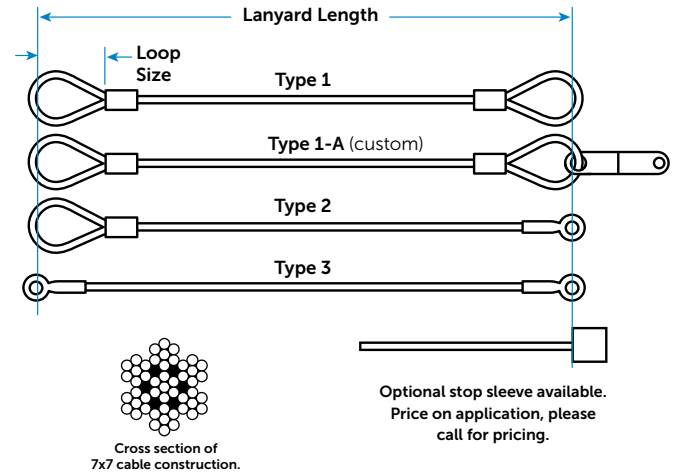

Steel Lanyard Specs

Cable Diameter	Diameter with Coating	Standard Loop Size (inches)	Standard Eyelet Diameter (inches)	Minimum Breaking Strength (lbs.) (Cable Only)	Approx. Breaking Strength (lbs.) (Lanyard Assemblies)
3/64	1/16	3/4	.190	270	215
1/16	3/32	7/8	.190	480	385
3/32	1/8	1 or 1-1/4 (min.)*	.250	920	735
1/8	3/16	1-1/2 (min.)	.316	1700	1350

Unless otherwise noted, all dimensions are for reference only.
* 1" min. for stripped loops, 1-1/4" min. for unstripped loops.

Wire Rope Lanyards

STOCK CODE	Cable Diameter (inches)	Length (inches)	Type	Cable Material	Coating (inches)	Approximate Weight/Pounds per 100 Pieces
L47B-600-1	3/64	6	1	Galvanized	Bare cable	0.42
L47N-600-1	3/64	6	1	Galvanized	Nylon to 1/16	0.51
L47P-600-1	3/64	6	1	Galvanized	PVC to 1/16	0.50
L47B-600S-1	3/64	6	1	Stainless	Bare cable	0.42
L47N-600S-1	3/64	6	1	Stainless	Nylon to 1/16	0.51
L47P-600S-1	3/64	6	1	Stainless	PVC to 1/16	0.50
L47B-600-2	3/64	6	2	Galvanized	Bare cable	0.59
L47N-600-2	3/64	6	2	Galvanized	Nylon to 1/16	0.66
L47P-600-2	3/64	6	2	Galvanized	PVC to 1/16	0.65
L47B-600S-2	3/64	6	2	Stainless	Bare cable	0.59
L47N-600S-2	3/64	6	2	Stainless	Nylon to 1/16	0.66
L47P-600S-2	3/64	6	2	Stainless	PVC to 1/16	0.65
L47B-600-3	3/64	6	3	Galvanized	Bare cable	0.75
L47N-600-3	3/64	6	3	Galvanized	Nylon to 1/16	0.81
L47P-600-3	3/64	6	3	Galvanized	PVC to 1/16	0.80
L47B-600S-3	3/64	6	3	Stainless	Bare cable	0.75
L47N-600S-3	3/64	6	3	Stainless	Nylon to 1/16	0.81

Unless otherwise noted, all dimensions are for reference only.

Wire Rope Lanyards continued on page 27

Wire Rope Lanyards
Continued from page 26

STOCK CODE	Cable Diameter (inches)	Length (inches)	Type	Cable Material	Coating (inches)	Approximate Weight/Pounds per 100 Pieces
L47P-600S-3	3/64	6	3	Stainless	PVC to 1/16	0.80
L62B-600-1	1/16	6	1	Galvanized	Bare cable	0.75
L62N-600-1	1/16	6	1	Galvanized	Nylon to 3/32	1.10
L62P-600-1	1/16	6	1	Galvanized	PVC to 3/32	0.95
L62B-600S-1	1/16	6	1	Stainless	Bare cable	0.75
L62N-600S-1	1/16	6	1	Stainless	Nylon to 3/32	1.10
L62P-600S-1	1/16	6	1	Stainless	PVC to 3/32	0.95
L62B-600-2	1/16	6	2	Galvanized	Bare cable	1.20
L62N-600-2	1/16	6	2	Galvanized	Nylon to 3/32	1.38
L62P-600-2	1/16	6	2	Galvanized	PVC to 3/32	1.26
L62B-600S-2	1/16	6	2	Stainless	Bare cable	1.20
L62N-600S-2	1/16	6	2	Stainless	Nylon to 3/32	1.38
L62P-600S-2	1/16	6	2	Stainless	PVC to 3/32	1.26
L62B-600-3	1/16	6	3	Galvanized	Bare cable	1.48
L62N-600-3	1/16	6	3	Galvanized	Nylon to 3/32	1.87
L62P-600-3	1/16	6	3	Galvanized	PVC to 3/32	1.59
L62B-600S-3	1/16	6	3	Stainless	Bare cable	1.48
L62N-600S-3	1/16	6	3	Stainless	Nylon to 3/32	1.87
L62P-600S-3	1/16	6	3	Stainless	PVC to 3/32	1.59
L47B-1200-1	3/64	12	1	Galvanized	Bare cable	0.63
L47N-1200-1	3/64	12	1	Galvanized	Nylon to 1/16	0.77
L47P-1200-1	3/64	12	1	Galvanized	PVC to 1/16	0.77
L47B-1200S-1	3/64	12	1	Stainless	Bare cable	0.63
L47N-1200S-1	3/64	12	1	Stainless	Nylon to 1/16	0.77
L47P-1200S-1	3/64	12	1	Stainless	PVC to 1/16	0.77
L47B-1200-2	3/64	12	2	Galvanized	Bare cable	0.80
L47N-1200-2	3/64	12	2	Galvanized	Nylon to 1/16	0.92
L47P-1200-2	3/64	12	2	Galvanized	PVC to 1/16	0.92
L47B-1200S-2	3/64	12	2	Stainless	Bare cable	0.80
L47N-1200S-2	3/64	12	2	Stainless	Nylon to 1/16	0.92
L47P-1200S-2	3/64	12	2	Stainless	PVC to 1/16	0.92
L47B-1200-3	3/64	12	3	Galvanized	Bare cable	0.96
L47N-1200-3	3/64	12	3	Galvanized	Nylon to 1/16	1.07
L47P-1200-3	3/64	12	3	Galvanized	PVC to 1/16	1.07
L47B-1200S-3	3/64	12	3	Stainless	Bare cable	0.96
L47N-1200S-3	3/64	12	3	Stainless	Nylon to 1/16	1.07
L47P-1200S-3	3/64	12	3	Stainless	PVC to 1/16	1.07
L62B-1200-1	1/16	12	1	Galvanized	Bare cable	1.15
L62N-1200-1	1/16	12	1	Galvanized	Nylon to 3/32	1.60
L62P-1200-1	1/16	12	1	Galvanized	PVC to 3/32	1.55
L62B-1200S-1	1/16	12	1	Stainless	Bare cable	1.15
L62N-1200S-1	1/16	12	1	Stainless	Nylon to 3/32	1.60
L62P-1200S-1	1/16	12	1	Stainless	PVC to 3/32	1.55
L62B-1200-2	1/16	12	2	Galvanized	Bare cable	1.60
L62N-1200-2	1/16	12	2	Galvanized	Nylon to 3/32	1.88
L62P-1200-2	1/16	12	2	Galvanized	PVC to 3/32	1.86
L62B-1200S-2	1/16	12	2	Stainless	Bare cable	1.60
L62N-1200S-2	1/16	12	2	Stainless	Nylon to 3/32	1.88
L62P-1200S-2	1/16	12	2	Stainless	PVC to 3/32	1.86
L62B-1200-3	1/16	12	3	Galvanized	Bare cable	1.88
L62N-1200-3	1/16	12	3	Galvanized	Nylon to 3/32	2.37
L62P-1200-3	1/16	12	3	Galvanized	PVC to 3/32	2.19
L62B-1200S-3	1/16	12	3	Stainless	Bare cable	1.88
L62N-1200S-3	1/16	12	3	Stainless	Nylon to 3/32	2.37
L62P-1200S-3	1/16	12	3	Stainless	PVC to 3/32	2.19

CUSTOM

Per your Imagination!

Custom Wire Rope Lanyards



We specialize in custom wire rope lanyards to suit your specific application. Virtually endless configurations are available - limited only by your imagination!

Common end fittings for wire rope lanyards include: sleeves (for loops), stop sleeves, thimbles, stamped eyelets, mounting tabs, ball ends, ball shanks, threaded studs and more.

Typical wire rope coatings include PVC and Nylon. PVC coating is more popular because of its appearance, flexibility and low cost. Nylon offers more durability and abrasion resistance. Coatings are available in many colors.

Contact us today to help you create the perfect wire rope lanyard for your application.



CUSTOM DESIGN CHECKLIST

- Cable Diameter
- Cable Length
- End Fittings
- Coating



DIY Assemblies

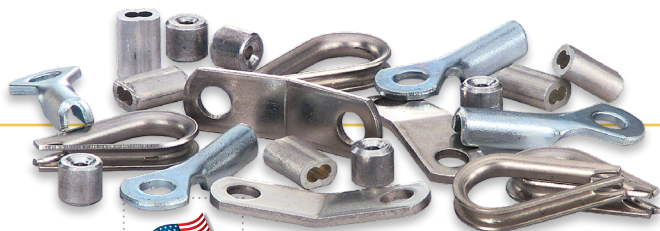

End Fittings

Various end fittings are available for you to choose from. Any combination of fittings may be used for the wire rope lanyard assemblies we supply.

A selection of fittings are available from stock – allowing you to make your own wire rope lanyard assemblies. We can advise correct assembly procedures for your application.



Eyelets

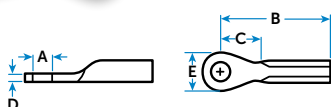

Eyelets allow for mounting the lanyard end using screws, rivets or bolts/nuts. For proper selection, please note the mounting hole size (A). Eyelets require specialized equipment for crimping.

STOCK CODE ZINC PLATED	STAINLESS STEEL STOCK CODE	Fits Bare Cable Diameter	Hole Diameter A	Length to Hole Center B	C	Thickness D	Outside Diameter E
EYE-47-157	EYE-47S-157	3/64	.157	.750	.260	.047	.330
EYE-47-160	EYE-47S-160	3/64	.160	.715	.315	.060	.320
EYE-47-1	EYE-47S-1	3/64	.190	.725	.215	.060	.340
EYE-62-129	EYE-62S-129	1/16	.129	.650	.340	.035	.380
EYE-62-1	EYE-62S-1	1/16	.190	.987	.317	.060	.460
EYE-62-194	EYE-62S-194	1/16	.194	.650	.340	.035	.380
EYE-62-204	EYE-62S-204	1/16	.204	.978	.400	.060	.460
EYE-62-2	EYE-62S-2	1/16	.260	.987	.317	.060	.460
EYE-62-315	EYE-62S-315	1/16	.315	1.00	.370	.060	.625
EYE-62-376	EYE-62S-375	1/16	.376	1.00	.370	.060	.625
EYE-62-438	EYE-62S-438	1/16	.438	1.00	.370	.060	.625
EYE-94-1	EYE-94S-1	3/32	.205	1.42	.470	.093	.500
EYE-94-2	EYE-94S-2	3/32	.250	1.42	.390	.090	.500
EYE-94-3	EYE-94S-3	3/32	.375	1.31	.450	.093	.750
EYE-94-500	EYE-94S-500	3/32	.500	1.31	.450	.093	.750
EYE-125-250	EYE-125S-250	1/8	.250	1.95	.480	.125	.580
EYE-125-316	EYE-125S-316	1/8	.316	1.95	.480	.125	.580
EYE-125-375	EYE-125S-375	1/8	.375	1.84	.540	.125	.850
EYE-125-500	EYE-125S-500	1/8	.500	1.84	.540	.125	.850

Unless otherwise noted, all dimensions are for reference only.



Mounting Tabs

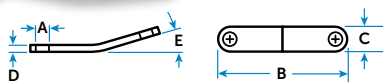

Mounting Tabs allow for mounting the lanyard end using screws, rivets or bolts/nuts. For proper selection, please note the mounting hole size (A). Mounting Tabs allow for greater freedom of movement of the wire rope lanyard itself, compared to eyelets.

STOCK CODE	Material	Fits Bare Cable Diameter	Hole Diameter A	Overall Length B	Width C	Thickness D	Bend Angle E
TAB-62-S	300 Series Stainless Steel	3/64 - 1/8	.194	1.262	.375	.062	15°
TAB-62S-203	304 Stainless Steel	3/64 - 1/8	.203	1-1/4*	.500	.060	20°
TAB-256S-F	300 Series Stainless Steel	3/64 - 1/8	.256	.860	.500	.062	30°
TAB-62S-281	304 Stainless Steel	3/64 - 1/8	.281	1-1/4*	.500	.060	20°
TAB-62-S1	300 Series Stainless Steel	3/64 - 1/8	.281	1.263	.375	.062	15°
TAB-26-437	Zinc Plated Steel	3/64 - 1/8	(1).437/(1).250	2.0	1.00	.060	No Bend
TAB-62S-285*	304 Stainless Steel	3/64 - 1/16	(1).285/(1).08	1.41*	.750		12°

*NOTE: TAB-62S-285 is teardrop shaped



Sleeves for Loops

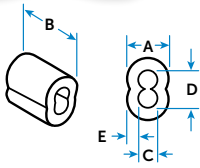

Lanyard cable is passed through the sleeve and fed back through to form a loop on the lanyard end. Sleeve is then crimped tight onto the cable. Use loops to attach to fasteners, pins or other components; or to loop the lanyard around itself and onto equipment.

STOCK CODE ALUMINUM	STOCK CODE 300 SERIES STAINLESS STEEL	STOCK CODE COPPER	Fits Cable Diameter	Dimensions				
				A	B	C	D	E
SLA-47	SLA-47-S	SLA-47-C	3/64	.149	.375	.055	.116	.045
SLA-62	SLA-62-S	SLA-62-C	1/16	.175	.375	.085	.160	.050
SLA-94	SLA-94-S	SLA-94-C	3/32	.281	.500	.121	.253	.080
SLA-125	SLA-125-2	SLA-125-C	1/8	.343	.625	.156	.313	.093

Unless otherwise noted, all dimensions are for reference only.



Ball Ends

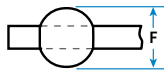

Use ball ends for "hanger"-type applications where assemblies can be removed easily. Ball ends allow the lanyard to swivel. Ball ends require specialized equipment for crimping.

STOCK CODE	Material	Fits Cable Diameter	Dimensions (F)	Specification
BALLEND-47S	Stainless Steel	3/64	.188	Commercial
BA3-1.5	Stainless Steel	3/64	.188	NAS494*
BALLEND-62S	Stainless Steel	1/16	.188	Commercial
BA3-2	Stainless Steel	1/16	.188	NAS494*
BALLEND-94-S	Stainless Steel	3/32	.250	Commercial
BA3-3	Stainless Steel	3/32	.250	NAS494*
BALLEND-125S	Stainless Steel	1/8	.313	Commercial
BA3-E	Stainless Steel	1/8	.313	NAS494*

Unless otherwise noted, all dimensions are for reference only.

* Made in USA - DFAR Compliant



Ball & Shank

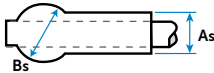

Use ball shanks for "hanger"-type applications where assemblies can be removed easily. Ball Shank ends allow the lanyard to swivel. Available to MS20664 specification or commercial grade. Ball shank ends require specialized equipment for crimping.

STOCK CODE	Material	Fits Cable Diameter	As	Bs	Specification
SHANK-47S	Stainless Steel	3/64	.112	.190	Commercial
SHANK-62S	Stainless Steel	1/16	.112	.190	Commercial
MS20664-C2	Stainless Steel	1/16	.112	.190	MS20664-C2
SHANK-94S	Stainless Steel	3/32	.143	.253	Commercial
MS20664-C3	Stainless Steel	3/32	.143	.253	MS20664-C3
SHANK-125S	Stainless Steel	1/8	.190	.315	Commercial
MS20664-C4	Stainless Steel	1/8	.190	.315	MS20664-C4

Unless otherwise noted, all dimensions are for reference only.



Double Shank Ball

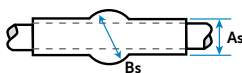

Available to MS20663 specification or commercial grade. Double Shank Ball ends require specialized equipment for crimping.

STOCK CODE	Material	Fits Cable Diameter	Dimensions		Specification
			As	Bs	
MS20663-C2	Stainless Steel	1/16	.112	.190	MS20663-C2
MS20663-C3	Stainless Steel	3/32	.143	.253	MS20663-C3
MS20663-C4	Stainless Steel	1/8	.190	.315	MS20663-C4

Unless otherwise noted, all dimensions are for reference only.



Stop Sleeves

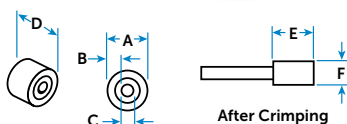

Stop sleeves are used in "hanger"-type applications where assemblies can be removed easily. A low cost end fitting!

STOCK CODE	Fits Bare Cable Diameter	Material	Dimensions				After Crimping	
			A	B	C	D	E	F
STP-47C	3/64	Copper	.172	.055	.063	.218	.273	.155
STP-62A	1/16	Aluminum	.247	.088	.075	.225	.340	.260
STP-94A	3/32	Aluminum	.347	.120	.110	.350	.610	.259
STP-125A	1/8	Aluminum	.343	.101	.140	.350	.522	.285

Unless otherwise noted, all dimensions are for reference only.



Threaded Ends

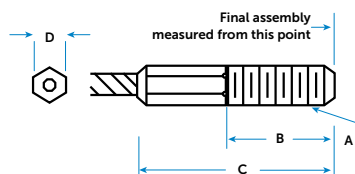

Threaded ends allow for panel-mounting as well as cable tightening.

STOCK CODE	Material	Fits Cable Diameter	Dimensions			
			A	B	C	D
TS47-50B	Brass	3/64 - 1/16	#10-24	1/2	1-1/8	5/32
TS47-50S	Stainless Steel	3/64 - 1/16	#10-24	1/2	1-1/8	5/32
TS47-100B	Brass	3/64 - 1/16	#10-24	1	1-5/8	5/32
TS47-100S	Stainless Steel	3/64 - 1/16	#10-24	1	1-5/8	5/32
TS47-125	Zinc Plated Steel	3/64 - 1/16	#10-32	1-1/4	1-7/8	5/32
TS47-125B	Brass	3/64 - 1/16	#10-32	1-1/4	1-7/8	5/32
TS47-125S	Stainless Steel	3/64 - 1/16	#10-32	1-1/4	1-7/8	5/32
TS62-75	Zinc Plated Steel	1/16 - 3/32	1/4-20	3/4	1-5/16	7/32
TS62-75B	Brass	1/16 - 3/32	1/4-20	3/4	1-5/16	7/32
TS62-75S	Stainless Steel	1/16 - 3/32	1/4-20	3/4	1-5/16	7/32
TS62-138	Zinc Plated Steel	1/16 - 1/8	1/4-28	1-3/8	2-3/16	7/32
TS62-138S	Stainless Steel	1/16 - 1/8	1/4-28	1-3/8	2-3/16	7/32
TS94-75	Zinc Plated Steel	3/32 - 1/8	1/4-20	3/4	1-9/16	7/32
TS94-75S	Stainless Steel	3/32 - 1/8	1/4-20	3/4	1-9/16	7/32
TS94-125	Zinc Plated Steel	3/32 - 1/8	1/4-20	1-1/4	2-1/16	7/32
TS94-125S	Stainless Steel	3/32 - 1/8	1/4-20	1-1/4	2-1/16	7/32
TS94-125-38	Zinc Plated Steel	3/32 - 3/16	3/8-16	1-1/4	2-1/4	5/16
TS94-125S-38	Stainless Steel	3/32 - 3/16	3/8-16	1-1/4	2-1/4	5/16
TS94-150	Zinc Plated Steel	3/32 - 1/8	1/4-20	1-1/2	2-5/16	7/32
TS94-150S	Stainless Steel	3/32 - 1/8	1/4-20	1-1/2	2-5/16	7/32
TS94-225	Zinc Plated Steel	3/32 - 3/16	3/8-16	2-1/4	3-1/4	5/16
TS94-225S	Stainless Steel	3/32 - 3/16	3/8-16	2-1/4	3-1/4	5/16
TS125-100	Zinc Plated Steel	1/8 - 5/32	5/16-18	1	1-15/16	9/32
TS125-100S	Stainless Steel	1/8 - 5/32	5/16-18	1	1-15/16	9/32
TS125-150	Zinc Plated Steel	1/8 - 5/32	5/16-24	1-1/2	2-7/16	9/32
TS125-150S	Stainless Steel	1/8 - 5/32	5/16-24	1-1/2	2-7/16	9/32
TS125-150-38	Zinc Plated Steel	1/8 - 3/16	3/8-24	1-1/2	2-1/2	5/16
TS125-150S-38	Stainless Steel	1/8 - 3/16	3/8-24	1-1/2	2-1/2	5/16
TS125-200	Zinc Plated Steel	1/8 - 5/32	5/16-18	2	2-15/16	9/32
TS125-200S	Stainless Steel	1/8 - 5/32	5/16-18	2	2-15/16	9/32

Unless otherwise noted, all dimensions are for reference only.



Thimbles

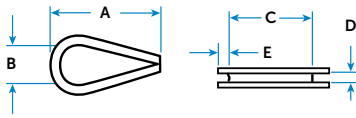

Thimbles are used in conjunction with a lanyard loop to increase cable life by increasing wear resistance as well as distributing the load on the cable over a larger area.

STOCK CODE	Fits Bare Cable Diameter	Material	Dimensions				
			A	B	C	D	E
TIM-62	1/16 - 5/64	CR Steel	.969	.35	.703	.094	.078
TIM-62S	1/16 - 5/64	300 Series S.S.	.969	.35	.703	.094	.078
TIM-94	3/32 - 1/8	CR Steel	1.000	.35	.703	.141	.078
TIM-94S	3/32 - 1/8	300 Series S.S.	1.000	.35	.703	.141	.078

Unless otherwise noted, all dimensions are for reference only.

New!



Carabiners

Carabiners are versatile quick-connect snap hooks. The opening gate is spring-loaded, automatically snaps closed and features an interlock tooth. Use with Wire Rope Lanyards, Nylon Lanyards, rope or other tethering methods. Carabiners without eyelets afford easy attachment to lanyards, while Carabiners with eyelets keep the lanyard or other tether in place at the bottom of the Carabiner. Available from stock in steel with zinc plating and stainless steel.

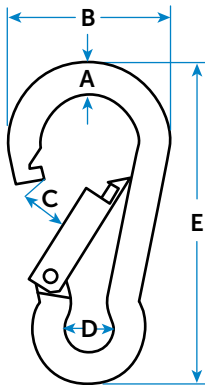

Carabiners

STOCK CODE	Material	Metric Sizes - all dimensions in millimeters					Approx. Weight/Pounds per 100 pieces
		A	B	C	D	E	
CARAB-187	Steel, Zinc Plated	5.0	26.5	7.0	8.0	50.0	3.48
CARAB-187S	316 Stainless	5.0	26.5	7.0	8.0	50.0	3.48
CARAB-250	Steel, Zinc Plated	6.0	30.0	7.5	8.5	60.0	5.95
CARAB-250S	316 Stainless	6.0	30.0	7.5	8.5	60.0	5.95
CARAB-312	Steel, Zinc Plated	8.0	40.5	10.0	12.0	80.0	13.78
CARAB-312S	316 Stainless	8.0	40.5	10.0	12.0	80.0	13.78
CARAB-375	Steel, Zinc Plated	9.0	45.0	10.5	14.0	90.0	20.04
CARAB-375S	316 Stainless	9.0	45.0	10.5	14.0	90.0	20.04

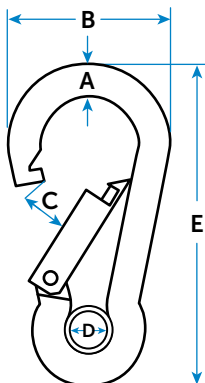

Carabiners – with Eyelets

STOCK CODE	Material	Metric Sizes - all dimensions in millimeters					Approx. Weight/Pounds per 100 pieces
		A	B	C	D	E	
CARABX-187	Steel, Zinc Plated	5.0	26.5	7.0	7.8	50.0	3.62
CARABX-187S	316 Stainless	5.0	26.5	7.0	7.8	50.0	3.62
CARABX-250	Steel, Zinc Plated	6.0	30.0	7.5	8.7	60.0	6.08
CARABX-250S	316 Stainless	6.0	30.0	7.5	8.7	60.0	6.08
CARABX-312	Steel, Zinc Plated	8.0	40.0	10.0	10.8	80.0	14.07
CARABX-312S	316 Stainless	8.0	40.0	10.0	10.8	80.0	14.07
CARABX-375	Steel, Zinc Plated	9.0	45.0	10.5	12.0	90.0	20.41
CARABX-375S	316 Stainless	9.0	45.0	10.5	12.0	90.0	20.41

Unless otherwise noted, all dimensions are for reference only.

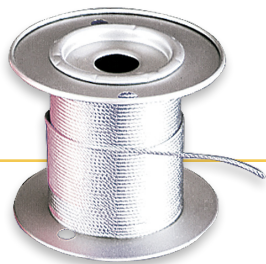
STAINLESS
STOCKED

Bulk Cable

Bulk aircraft cable cut to length or on spools is available from stock in galvanized steel or stainless, bare or coated. Construction is 7x7 aircraft quality for strength and flexibility. Sold by the foot.

Bulk Cable

STOCK CODE Galvanized Steel	STOCK CODE Stainless Steel (300 Series)	SIZE/COATING 7 x 7 Construction	Minimum Breaking Strength (lbs.)	Approximate Weight/Pounds per 100 Ft.
GAC-47-B	SAC-47-B	3/64 Bare Cable	270	.42
GAC-47-P	SAC-47-P	3/64 PVC Coated To 1/16	270	.52
GAC-47-N	SAC-47-N	3/64 Nylon Coated To 1/16	270	.54
GAC-62-B	SAC-62-B	1/16 Bare Cable	480	.75
GAC-62-P	SAC-62-P	1/16 PVC Coated To 3/32	480	1.00
GAC-62-N	SAC-62-N	1/16 Nylon Coated To 3/32	480	1.20
GAC-94-B	SAC-94-B	3/32 Bare Cable	920	1.60
GAC-94-P	SAC-94-P	3/32 PVC Coated To 1/8	920	2.10
GAC-94-N	SAC-94-N	3/32 Nylon Coated to 1/8	920	2.30
GAC-125-B	SAC-125-B	1/8 Bare Cable	1700	2.85
GAC-125-P		1/8 PVC Coated To 3/16	1700	4.00
GAC-125-N		1/8 Nylon Coated to 3/16	1700	4.50

Unless otherwise noted, all dimensions are for reference only.

Cable Cutter & Crimp Tool

Make your own cable assemblies in house using this versatile and durable tool. The dual purpose Cutter/Crimping tool tightly crimps aluminum oval sleeves, and features a built-in cable cutter. Cuts cleanly without fraying the end of the cable.



WARNING: Always wear eye protection when using this tool.

Cable Cutter/Crimp Tool

STOCK CODE	Description	Crimping Range	Length	Weight Each (lbs.)
CCT-WCI	Cable Cutter/Crimp Tool	1/32", 3/64", 1/16"	9"	.75

Unless otherwise noted, all dimensions are for reference only.